

2014

# BioTechnology

*An Indian Journal*

FULL PAPER

BTAIJ, 10(19), 2014 [11792-11797]

## Research on shape form strategy of interior design

Jun Ling Zhou, Ling Feng Xie

School of design, Shunde Polytechnic, Foshan 528000, (CHINA)

The school of architecture, South China University of Technology, Guangzhou  
510260, (CHINA)

### ABSTRACT

With the development of China's economy and society, the living environment plays an important role in people's daily life, and the interior design has become a hot issue, which should be paid more attention for China's development. For these Western developed countries, the interior design have been very mature, but that in China still needs to be improved. When it comes to interior design and decoration, it is general to pursue foreign design styles and techniques blindly, but to neglect China's native and ethnic characteristics. So China's interior design should blaze its new and unique path. The shape form is ubiquitous in people's lives, which makes people's life more colorful. The application of shape form in interior design can enrich the style and techniques of interior design and may exert a positive influence. This essay conducts a study on the strategies about the shape form in interior design.

### KEYWORDS

Interior design; Shape form; Strategy.

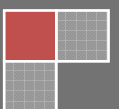

**INTRODUCTION**

Along with the continuous improvement of people's living standard, there is a new understanding and requirement of Interior design and decoration. However, in most cases, the shape form in interior design is neglected, resulting in an unsatisfactory effect on decoration, so it is necessary to master the quality of shape form and then make some research on the shape form. The appropriate application of shape form in interior design contributes to a more satisfactory decoration. This essay conducts a study on the strategies about the shape form in interior design.

**BRIEF INTRODUCTION OF SHAPE FORM**

**Introduction of shape, form and constitute**

The “shape” refers to things’ external outlines, the natural features and forms of an object shown in the real life. The “form” refers to surface attachment. One with a shape must have a form. The shape form consists of natural shape form, artificial shape form, abstract shape, concrete shape and intent shape, which refer to the specific impressions and feelings that observers have in the specific environment and time. When the “shape” and “form” are blended together, we can simply see them as the natural form of an object and the human’s expression towards the object. The distinctiveness of an object’s shape form is its shape form, while the conformation of psychological feeling is human’s expression of the object.

The term “constitute” first appeared in German, while construction, composition, form, and style share the similar meaning with constitute. The term “constitute” has two definitions. In a broad way, the term constitute is a rational and logical thinking, used as the “body” language in construction field. In a narrow way, the design elements may be edited, organized and abstracted in accordance with certain formal methods, in order to make the design modeling behavior fit the requirement, which is a scientific method of creation and cognition.

According to the current knowledge and understanding of shape form in interior design, it is to design the entire works of art in interior design to represent the spatial atmosphere and connotation and to enhance the spatial appearance. By strengthening the spatial visual effect, people’s aesthetic demands will be met, and the specific spatial connotation and atmosphere will be presented, which is the purpose of shape form in interior design.

**Graphic and color shape form**

**Graphic shape form**

The design in two-dimensional form reflects the understanding of the surface. In the two-dimensional surface, Designers often use simple techniques to achieve an abstract simplification of form. When it comes to design, in accordance with the designer's intent, the points, lines and surfaces of other basic visual elements are fused by certain design rules, so that it constitutes a complete design works, and will be rendered from a visual perspective, which is the meaning of graphic constitute.

**Color shape form**

The presence of color only can be seen by the action of sunlight. Beauty can be reflected through color, the color can also show the individuality of life. Therefore, the spatial ambience and indoors levels can be adjusted to affect people’s in the physical and psychological way.

**Graphic, color constitutes and inferior**

**Interior design and graphic constitute**

Essentially, the graphic constitute is the wide application of abstract points, lines and area elements based on the analysis of composition element energy and the improvement of abstract thinking abilities, to summarize, process, cut and restructure the three-dimensional objects on a two-dimensional surface. These elements can be widely used in every part in the field of art and they can render the interior design a unique aesthetic. There are many rules in the researches on graphic constitute, which can be seen in the TABLE 1:

**TABLE 1 : The rules of graphic constitute**

| Rules                | Detailed analysis   |
|----------------------|---|
| Symmetry and balance | The symmetry refers to the constitute with the same volume size and the same number of shape forms. The symmetry consists of left and right symmetrical constitute. Based on the center, the upper and lower parts are symmetrical with the circle as symmetric point or as the external beam radiation way, which is shown in the Figure 1. The balance refers to the visual balance between shape and form with different size and amounts. Its forms have the reflection, roation, move and expansion, which is shown in the Figure 2. |
| Repetition and group | In the natural environment, similar things have a regular beauty, which is seen as similar repetitive arranged graphic symbols by designers. To form a continuous link of the image is called as repetition, which can be seen in the Figure 3. The Group refers to a specific form of basic repetitive constitutes, which has its independent attributes, as we can see in the Figure 4  |
| Rhythm and rhyme     | According to a certain order of permutations and combinations, to form a sense of momentum is called as rhythm. Rhythm is to give a mood to the rhythm, to render the beat of the music full of energy, which can be seen in the Figure 5.  |

---

Contrast and harmony    Contrast is to emphasize the differences among different things, while harmony refers to the unity and comfortable degree among them.

---

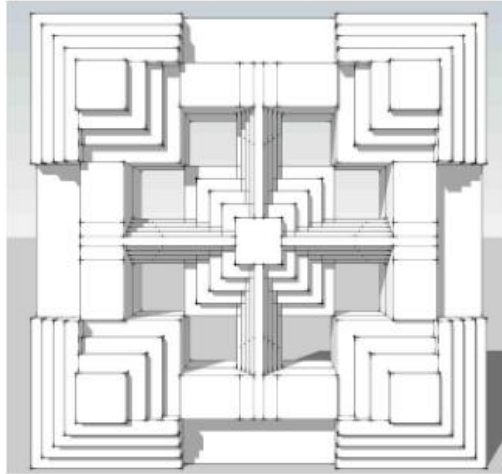

**Figure 1 : Symmetry form**

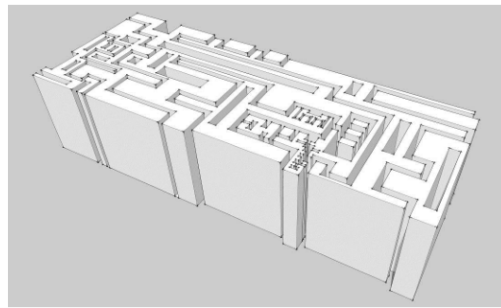

**Figure 2 : Balance form**

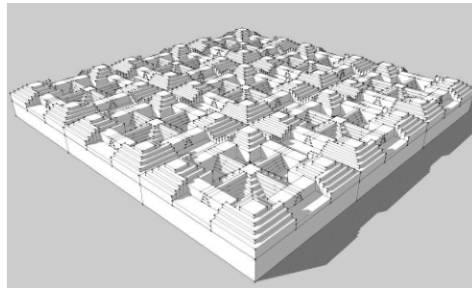

**Figure 3 : Repetition form**



**Figure 4 : Group form**

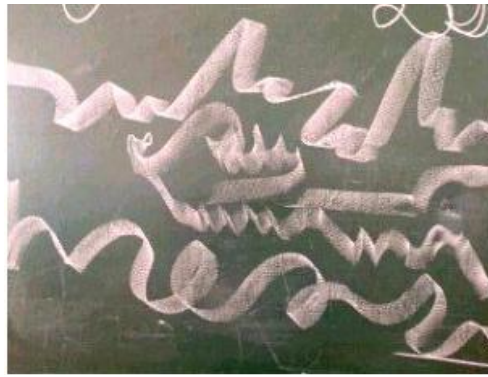

**Figure 5 : Rhythm and rhyme form**

### **Interior design and color constitute**

The color constitute is the layout on a particular object. Various color properties in space has its own specific combination which is the requirement in the art of color design. They will be orderly and rhythmically interrelated, influenced and complemented with each other in a certain proportion, which can constitute more harmonious color integration. For interior design, according to different objects, environment and space, the color matching should be flexible to reach the most beautiful visual experience of color.

### **Three-dimensional constitute and inferior**

The three-dimensional constitute, also called as spatial constitute, refers to a concrete object composition, including its length, width and height in a certain spatial environment. It is general to use some material to find a visual focal point, then based on the mechanical principles and aesthetic principles, the design elements are combined to render a better form. This constitute is not only limited to the researches on the abstract point, line, three-dimensional shape forms, but also contains the constitute rules of various design elements. In interior design, three-dimensional constitute is an important part, because all visible and tangible objects placed indoors belong to the three-dimensional constitute category. In order to present an ideal design effect in the interior design, it is necessary to adhere to the aesthetic principles, which also makes a higher demand for designers. They need to make a reasonable choice and arrangement on materials, colors, textures, shapes, shapes and other elements in order to design the best indoor works and to meet users' mental and spiritual needs. The factors of three-dimensional constitute are shown in the TABLE 2.

**TABLE 2 : Factors of three-dimensional constitute**

| <b>Factors</b>        | <b>Analysis</b>   |
|-----------------------|---|
| Repetitive constitute | Periodical and continuous repetitive moves based on an object. The repetitive constitute is an important part of designing spatial order.   |
| Gradient constitute   | This constitute can bring a visual perception in stages, but also present this form in the state of fusion. Continuous change and move based on similar objects is the essential characteristics of the gradient constitute.  |
| Specific constitute   | This constitute refers to the rules which breaks the regular and previous rules. Besides enhancing the visual effects, a different effect occurs too.   |
| Contrast constitute   | Comparisons among elements or between elements and the entire can lead to two different tensions. At the same time, a strong visual tension and clear space highlights are presented.   |
| Launch constitute     | It refers to a visual center formed in a gradient and special way. The launch constitute in interior design is based on a common center point as the center, and surrounding objects diverge outwards or concentrate inwards. |

## **STRATEGIES OF SHAPE FORM IN INTERIOR DESIGN**

### **The application of graphic constitute design in interior design**

The graphic constitute is vital to the interior environment. The graphic constitute is the most basic design activity in the two-dimensional space. According to the form principles to assemble and decompose, it may constitute an ideal form. In interior design, the graphic constitute is significant to Basic design ability and creativity and its main components include points, lines and surfaces. When it comes to interior design, in accordance with the basic principles and the form principles, various factors should be drawn on the preliminary graphic plan paper, including the application of materials, artistic style, functional requirements, process, cost, spiritual ideas, budget and other factors. There are many form principles to be applied,

including repetition, rhythm, focus, contrast, proportion, harmony, balance, rhythm, and so on. From the broad perspective, the indoor floor, interior ceiling and interior wall should be applied into the graphic constitute of interior design. The graphic constitute is more prominent in the interior wall design, because each wall is like a white picture and every design and element on the wall should be considered as unit designs and patterns of this constitute. First, each unit design and patterns have different size and shapes, and their positions are also varied, big or small, centered or divergent. Second, during the designs of floor, ceiling and wall, elements, such as points, lines and surfaces should be used, but also other design of forms, like repetition, specific constitute and launch constitute. It is shown in the Figure 6, Figure 7 and Figure 8.



**Figure 6 : The application of the repetitive constitute of points in interior design**



**Figure 7 : The application of the launch constitute of lines in interior design**



**Figure 8 : The application of the specific constitute of surfaces in interior design**

### **The application of color constitute in interior design**

The design and spatial color indoors is directly determined by the color constitute. The interior color affects not only the visual environment, but also affects people's emotion and psychological conditions. The appropriate processing of color is not only consistent to functional requirements, but also can produce beautiful results. Regular color rules are necessary for interior design. Besides, it should be changed as the aesthetics changes. The mix and match of color should be paid more attention. Complementary colors can result in very sharp contrast configurations, often have a dramatic effect. Saturated colors are rarely used in home decoration, because they find it hard to believe that large amount of saturated color can achieve good results. But it is not true. If the saturated colors are used in an appropriate way, the effect will be outstanding. The relationship between primary and secondary color is the most important for the saturated colors matches. Generally, the color with high degrees of hue is the main color in the room. The colors with different degree of hue should be arranged as followed: the color with the brightest hue should be placed on the top; the color with the moderate hue should be placed in

the central wall; the color with relatively dark hue should be used on the floor or furniture. This color arrangement presents a clear color level and offers a relatively stable color visual psychological experience.

The color and hue in interior design should be unified. If the colors adopted belong to the some category, like red, dark red, blood red and medium red, which are only different in brightness, it offers a sense of dullness. Generally, furniture's colors have a darker hue and a less brightness, and the exception vice versa. For a better color effects, the placing of objects should adheres to the contrast method. For example, warm and cool colors and contrast, hue contrast, brightness contrast, clarity contrast, brightness and darkness contrast. For interior design, to tell unity from contrast and to find contrast out of unity should be presented, which is the only way to make hue unified, color bright and receive a sharp color contrast.

### The application of three-dimensional constitute in interior design

The plasticity of three-dimensional space is used by three-dimensional constitute design, organically combined with Ergonomics and creates three-dimensional models with perfect appearance, reasonable structure and functions which meet the respondent requirements. The pillars, wall and ceilings in interior space should be decorated appropriately and their decorations should be correspondent to their original functions. The three-dimensional constitute is vital for the three-dimensional design of interior space. First, in terms of interior space design and spatial structure, it is necessary to organically use the basic elements of the three-dimensional constitute, such as the space and shape of Spherical body, cone, rectangular body, cone and irregular shape body. Second, the three-dimensional constitute is critical for indoor appliances and furniture designs. Based on different types and functions of household appliances and furniture, the regulation and irregular design can be applied. As is shown in the Figure 9, the design is established on the basis of the factors of three-dimensional constitute and the basic principle of the three-dimensional constitute among factors (repetition, symmetry, composition, rhythm, arrangement, addition and subtraction, specific constitute and rhythm). Besides, for interior design, the three-dimensional design contains the decorative molding, such as walls and decorative walls, screens, columns and decorative columns, partitions and other decorative pieces, which is based on the three-dimensional constitute. In addition, materials, surface smoothness, texture, and style-related factors also play a part in it, which directly contribute to the appearance of the design.



**Figure 9 : Surface folding constitute (the three-dimensional constitute of furniture)**

### CONCLUSION

In term of interior design, people's lifestyle, spatial elements and psychological needs should be full taken into account. Besides, the match of artistic style, technical feasibility and other factors should be considered to recreate the quality of spatial environment. The designers hope that their creative designs can make indoor environment more comfortable, form more beautiful, function more reasonable and cost more appropriate. The shape form is the most basic design course in the art design. It is based on the analysis of surfaces, colors and stereo, whose appropriate application in interior design renders the interior environment a rational layout, color harmony, beauty of variety and rational proportion. This essay also discusses the strategies of shape form in interior design. First, the shape form is introduced and then the strategies of shape form in interior design are also discussed, including the application of graphic constitute design in interior design, the application of color constitute in interior design and the application of three-dimensional constitute design in interior design. The appropriate application of shape form in interior design can make the interior environment more beautiful and more satisfactory.

### REFERENCE

- [1] Liu Chuanzhi; Brief study on the application of shape form in interior design[J], *Literature Life*, (3), (2014).
- [2] Chen Xuexia; Brief study on the application of morphological structure and modern aesthetics in interior design[J], *Urban Construction Theory Research*, (15), (2011).
- [3] Tao Shengnan, Chen Weicheng; Research on the shape form of living room furnishings[J], *Literature Life*, (1), (2012).
- [4] Liu Chuanzhi; Study on the application of shape form in interior design[J], *Art and Design*, Hefei Technology University, (Graduate), (2013).
- [5] Lin Feng; Research on the form of spatial patterns in interior design[J], *Beauty Age and City*, (11), (2013).